

Turn System on/off

Press and hold Button for 3 seconds to turn on or off.
Select „Shutdown“ on the Screen to turn system off.

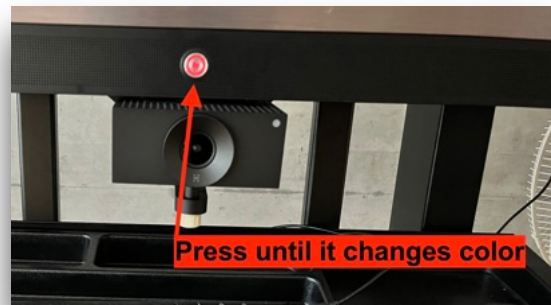

Select connection method:

1. Press “Input” on the remote control
2. Select the connection method on the touchscreen:

A Use Built-in PC (recommended)

Tap on „PC“ on the screen.
Use Touch-Screen to open the Apps you need (Zoom, Powerpoint,...).

B Use your own Notebook

B.1 Connect Wireless

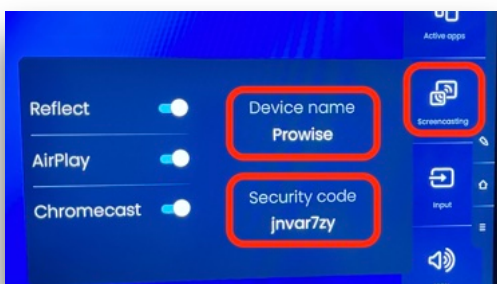

In the Touch-Screen menu on the right side choose „Screencasting“ and on your Notebook connect to the Prowise-Screen using the shown „Security Code“.

B.2 Connect via HDMI Cable

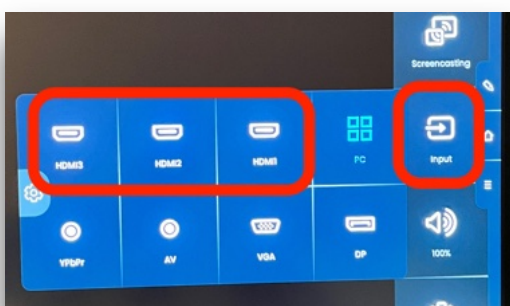

In the Touch-Screen menu on the right side choose „Input“ and the appropriate HDMI-Connector, where the cable is plugged in.

B.3 Use Speaker/Microphone/Camera System on your own PC

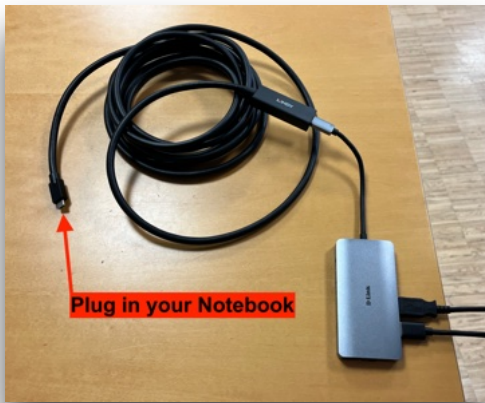

Unplug the USB-C Cable shown from the Screen (right side) and connect the cable to your Notebook.

C Zoom Settings for Speaker/Microphone/Camera

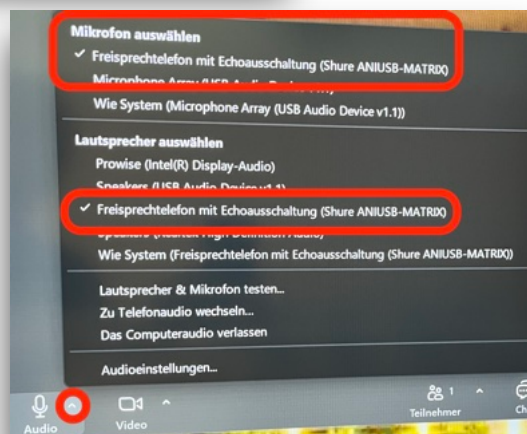
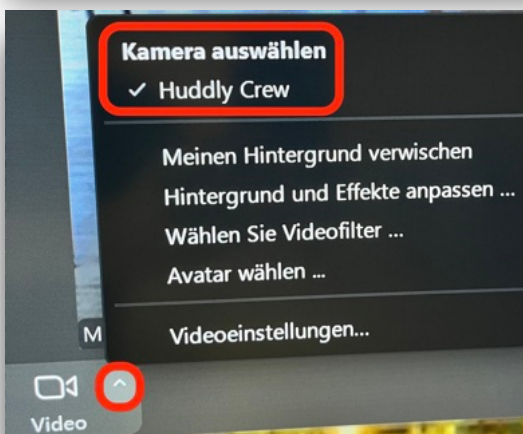
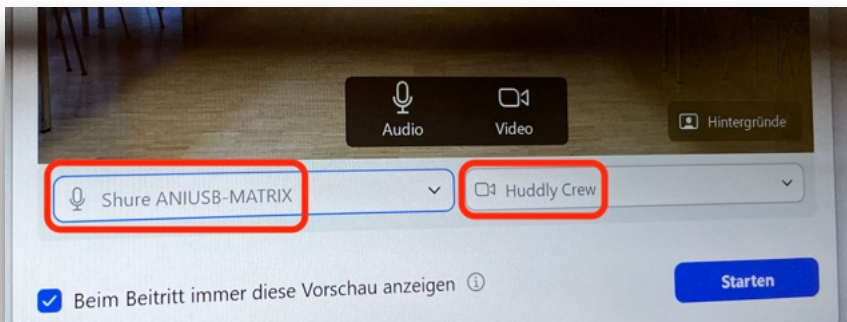

Use Windows/MacOS system settings to adjust speaker volume. (Windows: bottom right in taskbar, MacOS: top right in control center)